

Pictures are only illustrative. They can differ from the visual shape of the selected product variant.

## Description

TFF is a circular supply diffuser for ceiling installation. It has adjustable vent capacity and a 360° discharge pattern from which up to 180° can be shielded by a deflector.

## Highlights

- Easy, precise air flow volume adjustment
- Non-disturbant aesthetic form
- Easy installation

## Design

TFF is made from galvanized steel sheet with powder colour coating. The product consists of the fixed part with fixing springs, equipped duct connection, the valve seat and the movable valve front plate. The front plate is held by the central thread bolt and can be moved by rotating. So the gap between the plate and the seat can be adjusted to set the required air flow volume.

# TFF-160-SW

Article no.: 161931

## Configuration

Parameter	Value
Size	160
Surface finish	Signal white (RAL9003, gloss 30%)
Discharge	180°

Calculation

Pressure drop & sound power level (A-weighted)

Total sound power level (A-weighted) - Discharged into room

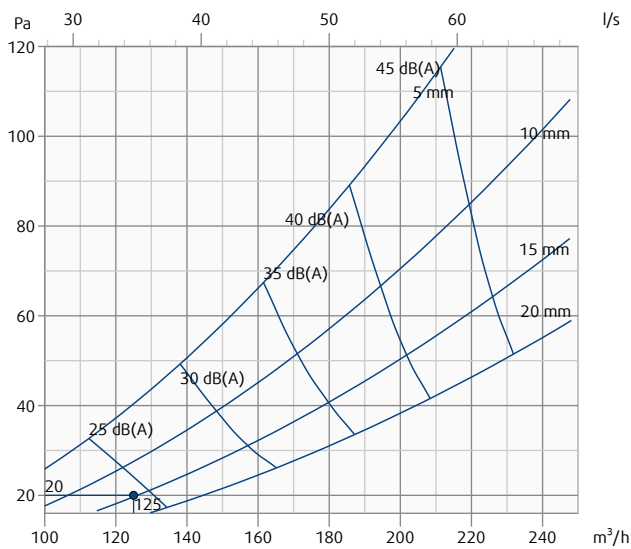

Throw length (terminal velocity 0.2 m/s)

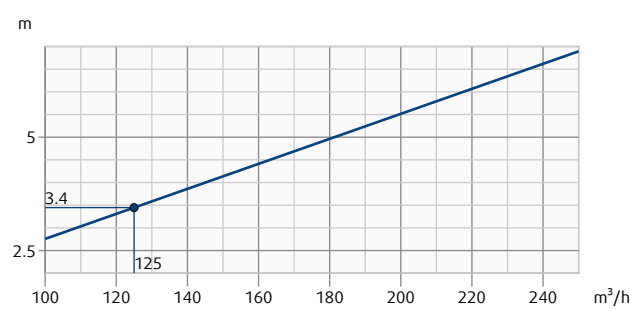

Parameter	Value	
Air flow	125	m³/h
Pressure drop	20	Pa
Room temperature	20	°C
Supply temperature	20	°C
Damper setting	65	%
Total sound power level - Discharged into room	39	dB
Total sound power level (A-weighted) - Discharged into room	25	dB(A)
Total sound pressure level (10 m² room absorption, A-weighted)	21	dB(A)

Total sound power level - Discharged into room									
	Hz	63	125	250	500	1k	2k	4k	8k
L <sub>W</sub>	dB	38	30	23	15	8	8	15	23
L <sub>WA</sub>	dB(A)	11	15	14	11	8	9	16	22

Flow pattern

Room width (X): 4.000 m  
Room depth (Y): 3.000 m  
Room height (Z): 2.800 m

Position X: 2.000 m  
Position Y: 1.500 m  
Position Z: 2.800 m  
Angle: 0 °

Custom

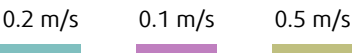
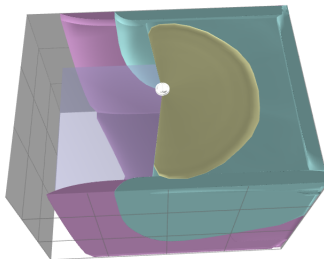

Top

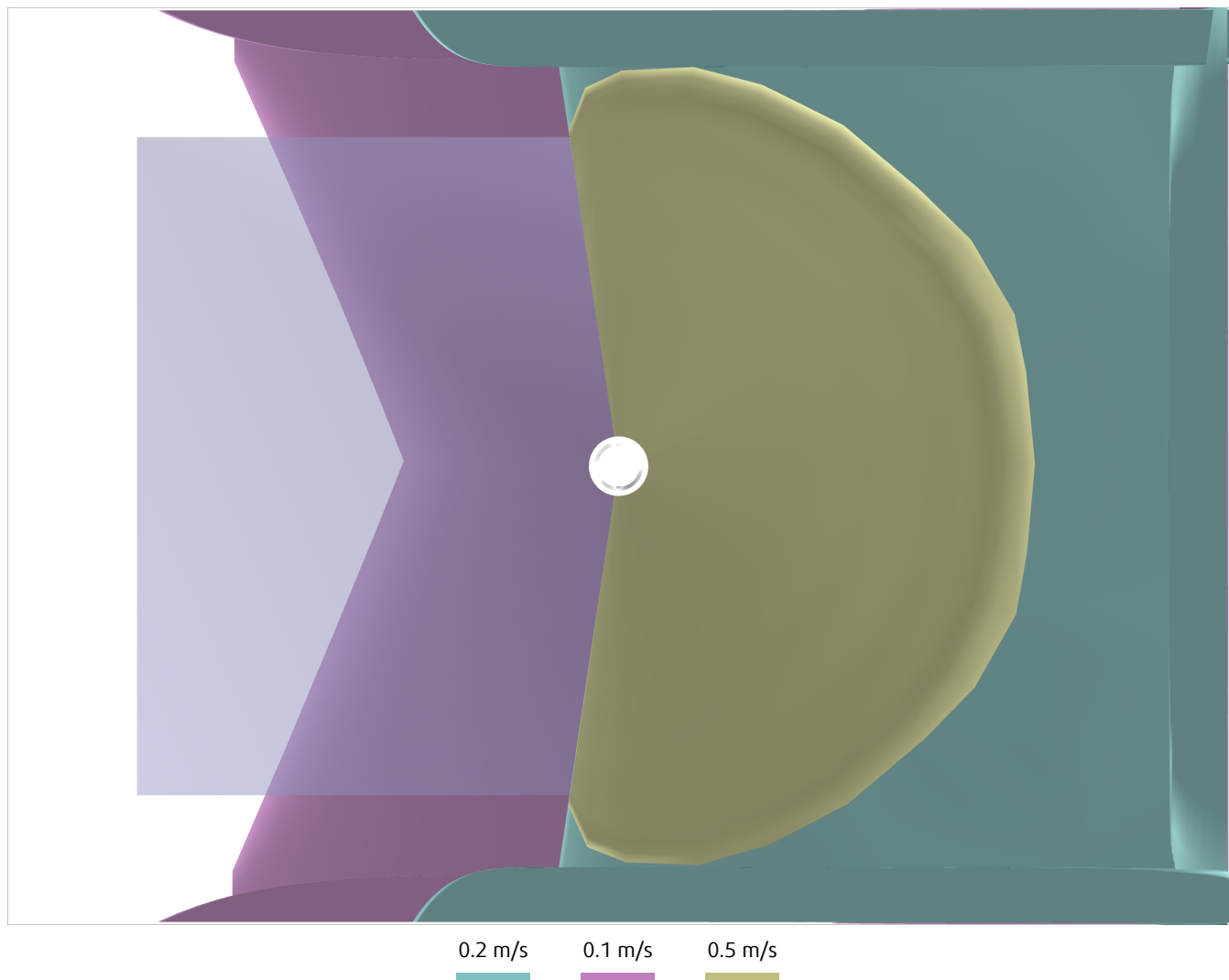

Left

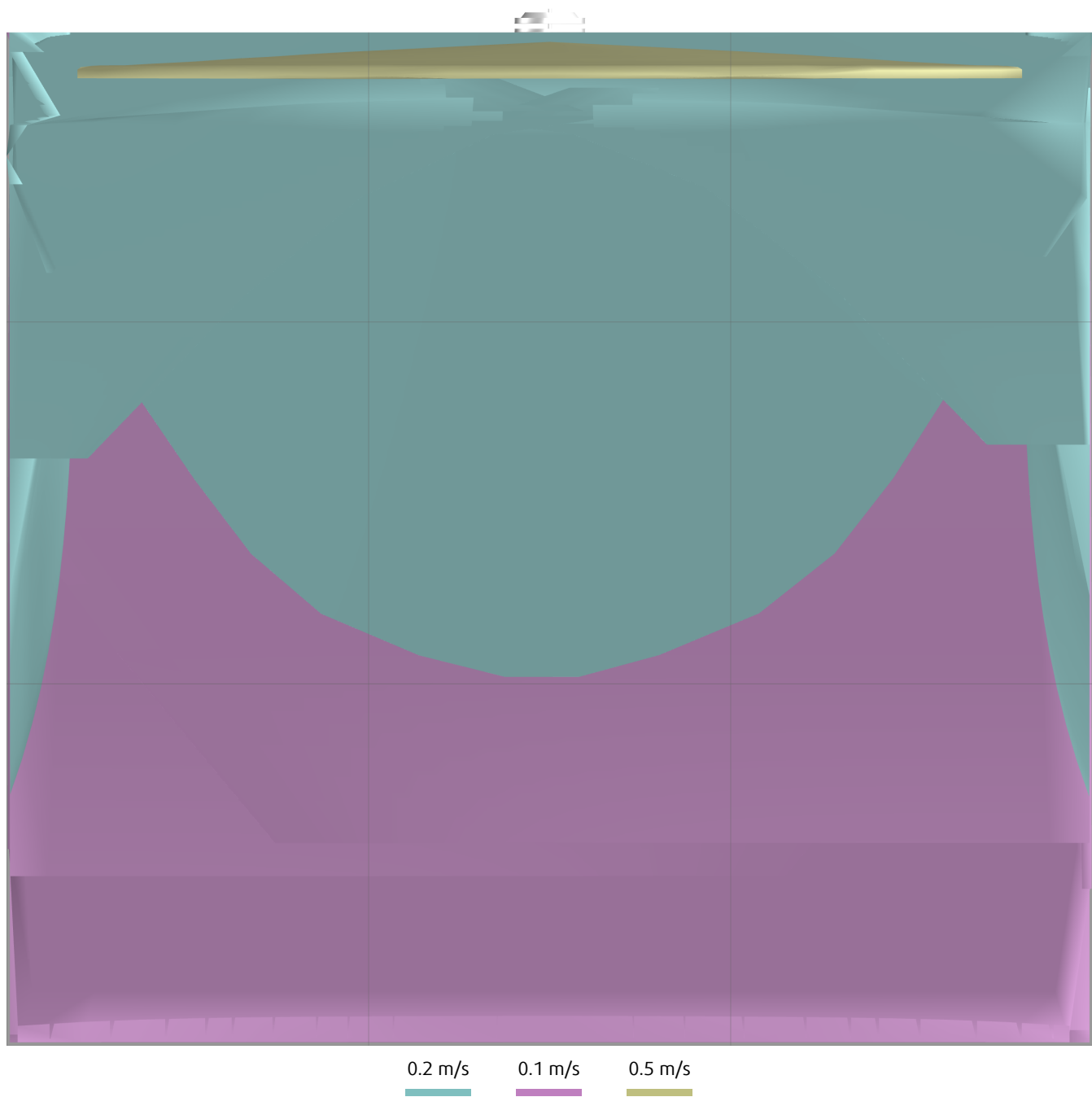

Southeast

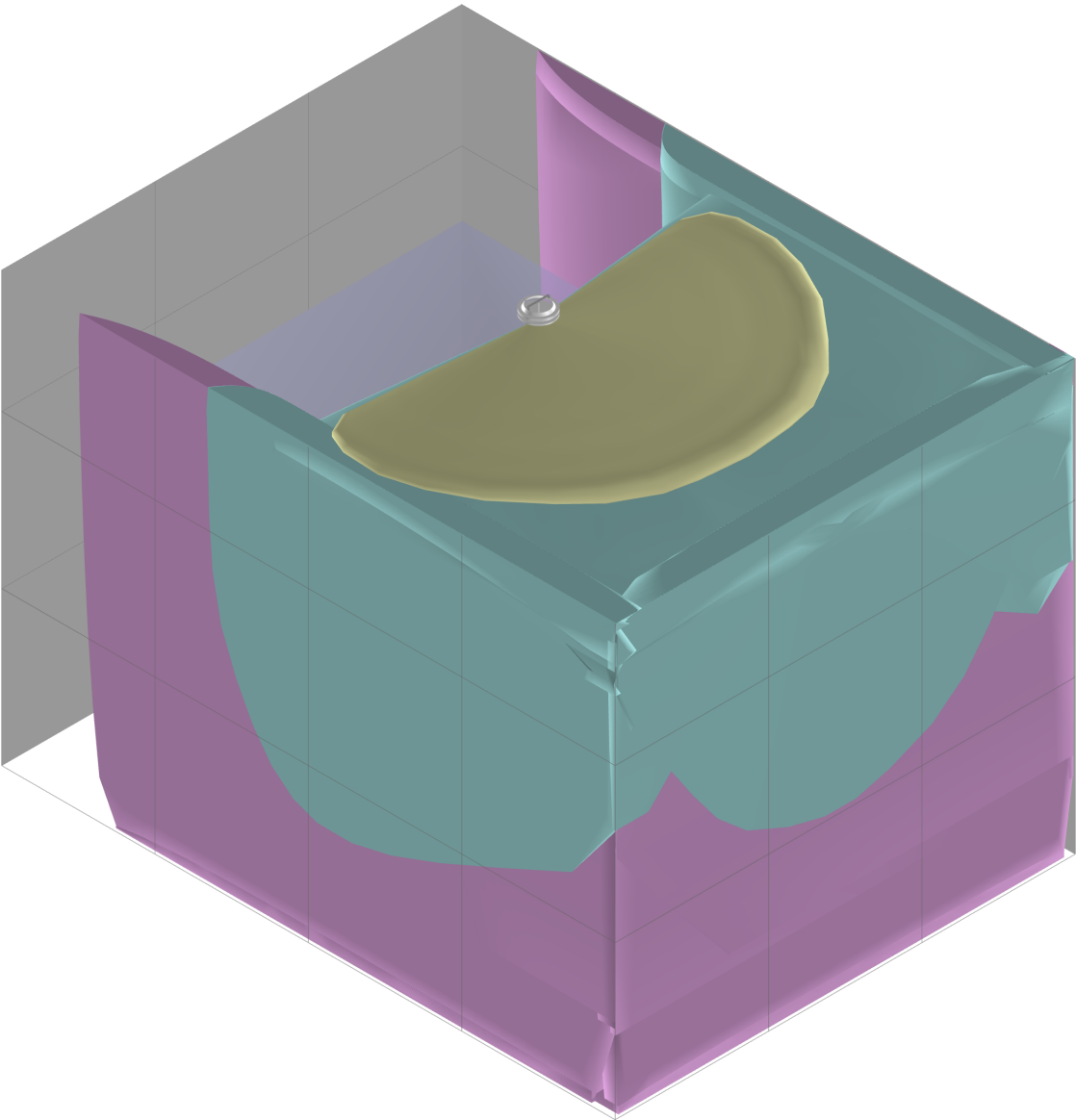

0.2 m/s      0.1 m/s      0.5 m/s

# TFF-160-SW

Article no.: 161931

## Dimensions

### Dimensions

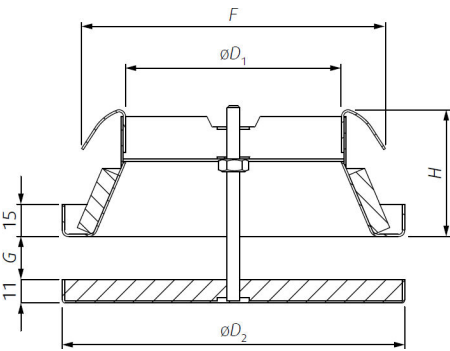

Dimensions	Value (mm)
$\varnothing D_1$	135
$\varnothing D_2$	188
F	180
G (max)	15
H	60

## Weight

Part	Weight (kg)
TFF-160-SW	0.47



## Documents

[DataSheet\\_TFF\\_EN\\_202105](#)

[DeclarationOfConformity\\_EFF,\\_EFFC,\\_TFF,\\_TFFC,\\_RSK,\\_IGC](#)

[UserManual\\_TFF\\_201909](#)